



**WESTGATE LAKES**  
**RESORT & SPA**

10000 Turkey Lake Road  
Orlando, Florida 32819  
Group Sales: 866-731-7259  
International: 407-355-1110  
[wglakes.com](http://wglakes.com)





The beautiful lakefront Westgate Lakes Resort & Spa is a tropical paradise that provides convenient access to the Orange County Convention Center, lies just 1.5 miles from SeaWorld® Orlando, 2 miles from Universal Orlando®, 6 miles from Walt Disney World® Resort and just 2.6 miles from the new Orlando Eye, Madame Tussauds Orlando and SEA LIFE Aquarium. Onsite amenities include seven heated outdoor pools, seven hot tubs, world-class Serenity Spa and award-winning Smokehouse Grill.

## RESORT OVERVIEW

- |   |   |  |
|---|---|--|
| <ul style="list-style-type: none"> <li>• Serenity Spa by Westgate</li> <li>• Westgate Smokehouse Grill<br/>– Serving Breakfast &amp; Dinner Lakeside with a Full Bar</li> <li>• Sid's Bistro</li> <li>• Starbucks</li> <li>• Cordovano Joe's Pizza</li> <li>• The Marketplace – Groceries, Sundries &amp; Gifts</li> <li>• Room &amp; Catering Services</li> <li>• 7 Heated Outdoor Pools</li> <li>• 7 Hot Tubs</li> <li>• 4 Children's Wading Pools</li> </ul> | <ul style="list-style-type: none"> <li>• 24-Hour Business Center</li> <li>• Fitness Center with Training Sessions</li> <li>• Tennis Court</li> <li>• Basketball Court</li> <li>• Volleyball Court</li> <li>• Miniature Golf</li> <li>• Bicycle Rentals</li> <li>• Playgrounds</li> <li>• Game Room</li> <li>• Horseshoes</li> <li>• Shuffleboard</li> <li>• Lakeside Marina &amp; Dock<br/>– Fishing; Paddle Boat, Pontoon &amp; Kayak Rentals</li> </ul> | <ul style="list-style-type: none"> <li>• Wi-Fi (fee may apply)</li> <li>• Free Scheduled Transportation to Theme Parks</li> <li>• Attraction Tickets Desk</li> <li>• VIP Services Concierge</li> <li>• ATM</li> <li>• 24-Hour Front Desk &amp; Security</li> <li>• Laundry Facilities</li> <li>• Activities Programs</li> <li>• Westgate Kid's Club</li> <li>• Pet Friendly Resort<br/>– One cat or dog up to 60 lbs. Deposits, fees and restrictions may apply</li> </ul> |
|---|---|--|





## ACCOMMODATIONS

---



### Studio Villa

Larger than a typical hotel room, the Studio Villa accommodates up to 4 guests and offers a pleasant retreat after a fun-filled day exploring theme parks. Relax on your private balcony or patio and enjoy the convenience of a kitchenette with mini refrigerator, microwave, coffee maker and toaster.



### One-Bedroom Villa

Enjoy all the comforts of home in the One-Bedroom Villa, which offers 400 square feet of space and accommodates up to 4 guests. Enjoy the convenience of a kitchenette with two-burner stove top, microwave, coffee maker and refrigerator, as well as a flat-screen TV and full bath with walk-in shower.



### One-Bedroom Deluxe Villa

Featuring an amazing 800 square feet of space, the One-Bedroom Deluxe Villa provides room for up to four guests to stretch out and relax. In-room amenities include a private balcony or patio, fully equipped kitchen with microwave and refrigerator, flat-screen TV and full bath with oversized jetted tub.



### Two-Bedroom Villa

The Two-Bedroom Villa provides the perfect setting for an unforgettable vacation or business trip. Enjoy 1,200 square feet of space and in-room amenities such as a king bed in the master bedroom, two double beds in the second bedroom, queen sleeper sofa, fully equipped kitchen, and private balcony or patio.



### Three-Bedroom Villa

With 1,690 square feet of space and room for up to 12 guests, the wonderfully decorated Three-Bedroom Villa offers astonishing spaciousness. Guests enjoy a variety of in-room amenities such as a fully equipped kitchen, private balcony or patio, separate dining and living area, washer/dryer, flat-screen TVs and Wi-Fi Internet access.



### Four-Bedroom Villa

Enjoy all the comforts of a home in the oversized Four-Bedroom Villa, which features an amazing 2,186 square feet of space and accommodates up to 16 guests. In-room amenities include a private balcony or patio, a fully equipped kitchen, two kitchenettes, separate dining and living areas, flat-screen cable TVs and Internet access.



### Four-Bedroom Presidential Villa

The Four-Bedroom Presidential Villa offers luxurious accommodations and an incredible spaciousness that includes 2,038 square feet of space with room for up to 12 guests. The wide variety of in-room amenities include a full kitchen, two partial kitchens, separate dining and living areas, flat-screen cable TVs and Internet access.

## MEETING SPACE

Number of Meeting Rooms: 15 (including deck and balcony)

Total Meeting Space: 31,829 sq. ft.

Largest Room Space: 15,163 sq. ft. (Grand Ballroom)

Smallest Room Space: 609 sq. ft. (Cypress Boardroom)

Outdoor Meeting Space: Pelican's Pool Deck

Largest Seating Capacity (Number of people): 1,263

Smallest Seating Capacity (Number of people): 10

**Westgate Lakes Resort & Spa**

Group Sales: 866-731-7259

International: 407-355-1110

groups@wgresorts.com

wglakes.com

MEETING SPACE ROOMS	SQUARE FOOTAGE	BANQUET rounds of 8	CLASSROOM	THEATRE	U-SHAPED
Versailles Ballroom	7,605 S.F.	464	546	958	218
Versailles A	2,216 S.F.	139	163	285	65
Versailles B	1,384 S.F.	77	98	173	39
Versailles C	1,859 S.F.	117	132	232	53
Versailles D	2,146 S.F.	131	153	268	61
Fontainebleau Ballroom	6,569 S.F.	406	468	819	185
Fontainebleau A	1,660 S.F.	108	118	207	47
Fontainebleau B	1,247 S.F.	69	89	155	35
Fontainebleau C	1,674 S.F.	105	119	209	47
Fontainebleau D	1,988 S.F.	124	142	248	56
Grand Ballroom	15,163 S.F.	870	1,083	1,895	433
Cypress Boardroom	609 S.F.	18	NA	NA	NA
Pre-Function Space	2,518 S. F.	NA	NA	NA	NA
Veranda Ballroom	2,285	125	150	100	46
Sunset Veranda	1,456	80	100	60	30
Oleander Ballroom	2,408	125	250	125	60
Oleander A	1,204	60	100	75	30
Oleander B	1,204	60	150	50	30
Pelican's Landing Pool Deck	7,500	350	N/A	N/A	N/A

18,000 sq. ft. of Luxurious Meeting Space at Westgate Lakes Resort & Spa. Situated with views of the city and atop seven floors, our flexible meeting and board room space will allow for attendance capacities ranging from 20 –900 people.

Grand Ballroom: 15,163 S.F.

Versailles Ballroom: 7,605 S.F.

Fontainebleau Ballroom: 6,569 S.F.

Cypress Boardroom: 609 S.F.

Pre-Function Space: 2,518 S.F.

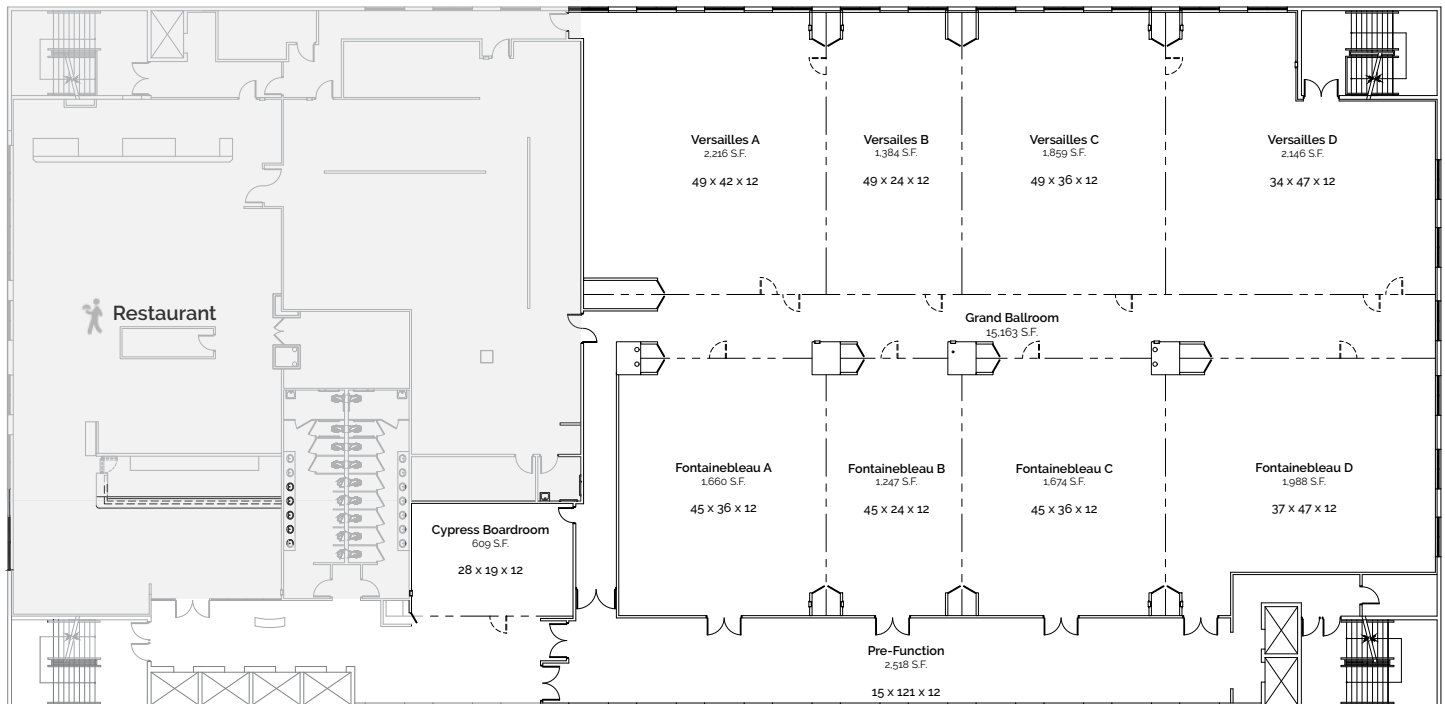

Dimensions LxWxH

